

INSTRUCTION TO BE FOLLOWED FOR THE MEMBRANE REPLACING

Suitable for interchangeable membrane expansion tanks from **2** to **24** litres capacity

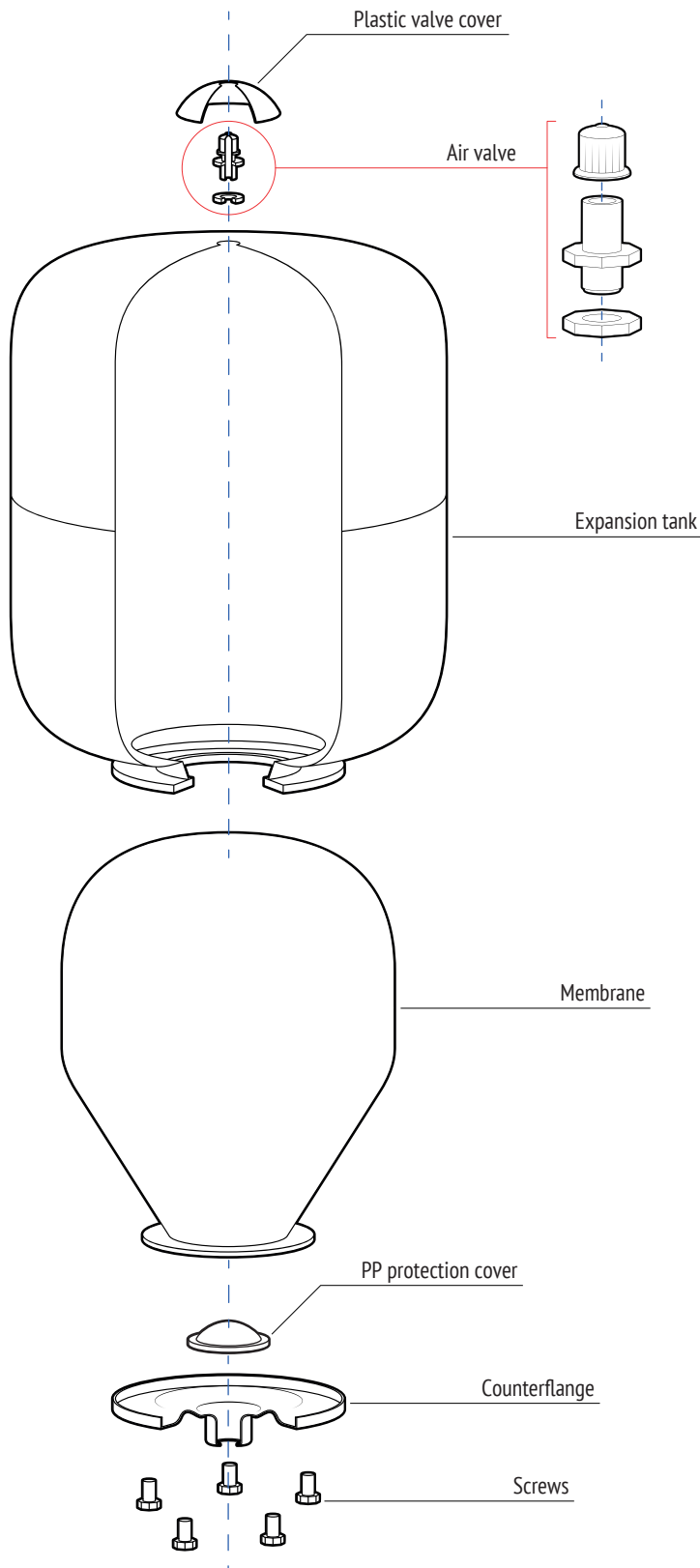

1. Empty the water and the air out of the expansion tank.
2. Unscrew the screws of the bottom counterflange and take it off.
3. Remove the membrane from the expansion tank.
4. Clean the interior surface of the expansion tank.
5. Insert the new membrane into the expansion tank.
6. Tighten the counterflange with the right screws.
7. Pre load the expansion tank to the required pressure as per CIMM label.

Always consult the use and maintenance instruction manual supplied with the expansion vessel.
All operations must be performed by competent expert personnel and under their own responsibility.
CIMM is not liable for damages caused by incorrect maintenance or incorrect operations.